

Suregrip Series

SB24 MIG TORCH



250A AIR COOLED MIG WELDING TORCH

Rating: 250A CO² 220A mixed gas EN60974-7 @ 60% duty cycle. 0.8 to 1.2mm wires

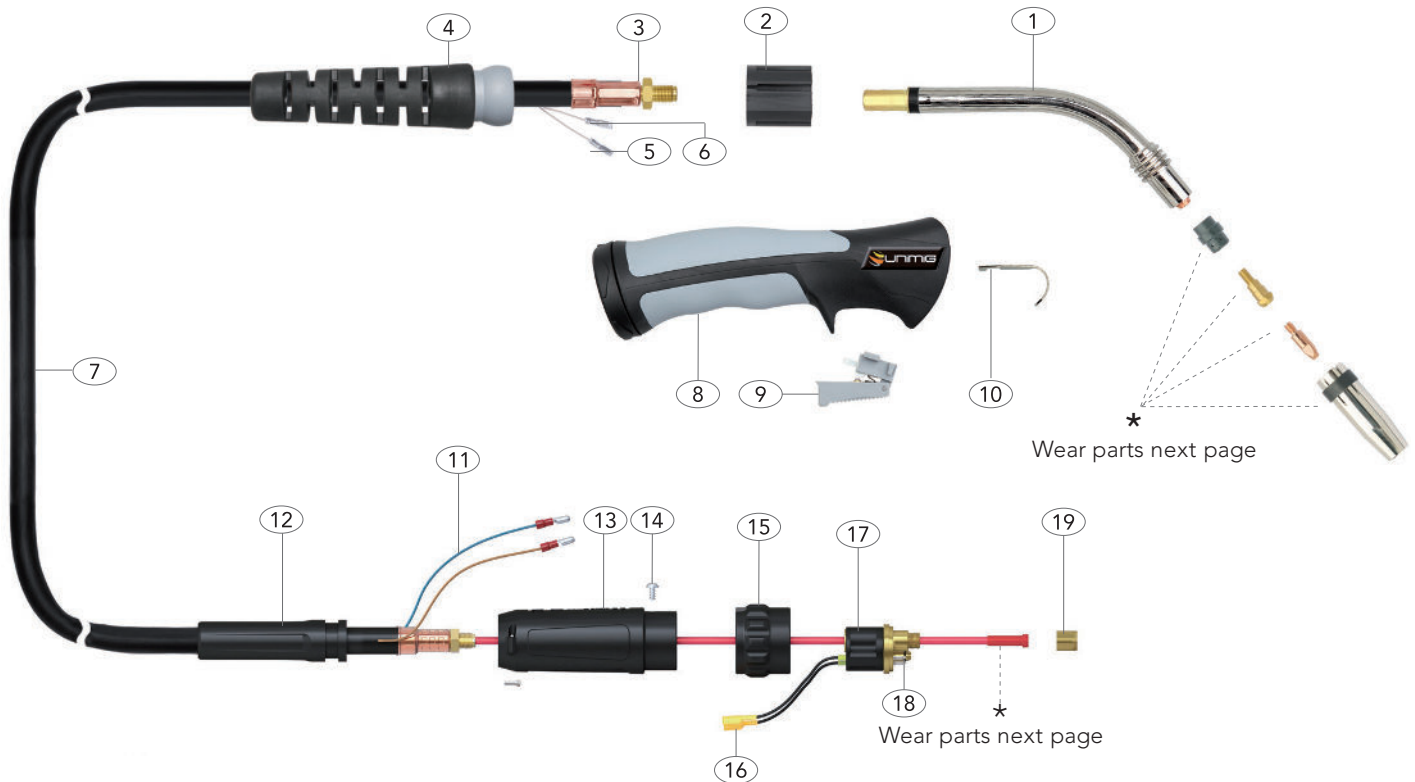

Torch Model Description	Part Number		
	3 Mt	4 Mt	5 Mt
SB Suregrip Ergo Torch Package	SB24-3M	SB24-4M	SB24-5M

Spare Parts					
Part Number	Description	Part Number	Description	Part Number	Description
1	SNK24	10	UB2517	10	Hanger Hook
2	UG1515	11	UB1522	11	Cable Terminal Male
3	UB1505	12	UPA2041	12	Cable Support
4	UG8015	13	UB1518	13	Gun Plug Housing C/W Nut
5	UB1521	14	UB1541	14	Gun Plug Screw
6	UB1521-C	15	UB1519/S	15	Gun Plug Nut
7	UB2603-30	16	UB1523	16	Gun Plug Terminal Female
	UB2603-40	17	UC1528	17	Hybrid Gun Plug Body C/W Spring Pins
	UB2603-50	18	UB1524	18	Gun Plug 'O' Ring
8	UG2514	19	UB1525	19	Liner Nut
9	UG2516				

Suregrip Series SB24 MIG TORCH



Front end consumables

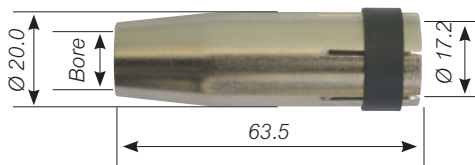
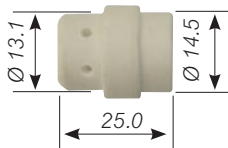
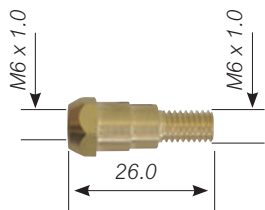
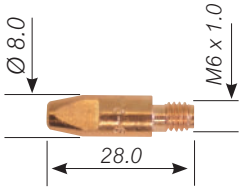

Liners

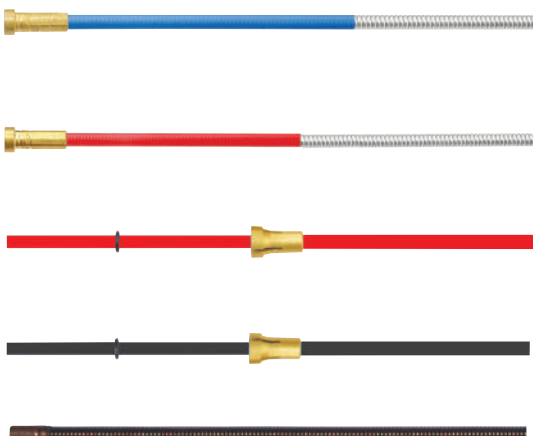

These parts are manufactured in China and are offered as replacement parts suitable for "BINZEL®" style torches.

SB24 Contact Tips

Part Number	Description	QTY
PCT0009-06	Contact Tip Steel (0.6mm)	QTY10
PCT0009-08	Contact Tip Steel (0.8mm)	QTY10
PCT0009-09	Contact Tip Steel (0.9mm)	QTY10
PCT0009-10	Contact Tip Steel (1.0mm)	QTY10
PCT0009-12	Contact Tip Steel (1.2mm)	QTY10
PCT0009-16	Contact Tip Steel (1.6mm)	QTY10
PCTZR009-09	Contact Tip Steel Long Life (0.9mm)	QTY10
PCTZR009-12	Contact Tip Steel Long Life (1.2mm)	QTY10
PCTAL0009-09	Contact Tip Aluminium (0.9mm)	QTY10
PCTAL0009-10	Contact Tip Aluminium (1.0mm)	QTY10
PCTAL0009-12	Contact Tip Aluminium (1.2mm)	QTY10

SB24 Tip Holder

Part Number	Description	QTY
PCTH24	Contact Tip Holder	QTY2

SB24 Gas Diffuser

Part Number	Description	QTY
PCGD24	Gas Diffuser	QTY2

SB24 Gas Nozzle

Part Number	Description	QTY
PGN24CYL	Cylindrical Nozzle	QTY2
PGN24CON	Conical Nozzle	QTY2
PGN24TAP	Tapered Nozzle	QTY2
PGN24SPOT	Spot Nozzle	QTY2

SB24 Liners

Part Number	Description	QTY
SLB3M	Blue Steel Liner 3 Metre	} 0.6 - 0.8mm
SLB4M	Blue Steel Liner 4 Metre	
SLB5M	Blue Steel Liner 5 Metre	
SLR3M	Red Steel Liner 3 Metre	} 0.9 - 1.2mm
SLR4M	Red Steel Liner 4 Metre	
SLR5M	Red Steel Liner 5 Metre	
TLB3M	Blue Aluminium Liner 3 Metre	} 0.6 - 0.8mm
TLB4M	Blue Aluminium Liner 4 Metre	
TLR3M	Red Aluminium Liner 3 Metre	} 0.9 - 1.2mm
TLR4M	Red Aluminium Liner 4 Metre	
TLY3M	Yellow Aluminium Liner 3 Metre	} 1.2 - 1.6mm
TLY4M	Yellow Aluminium Liner 4 Metre	
NKSTL	Neck Spring for Aluminium	